

ASSOUR CHAPE 19

DEFINITION

Thin sound-deadening underlay for floating floors.

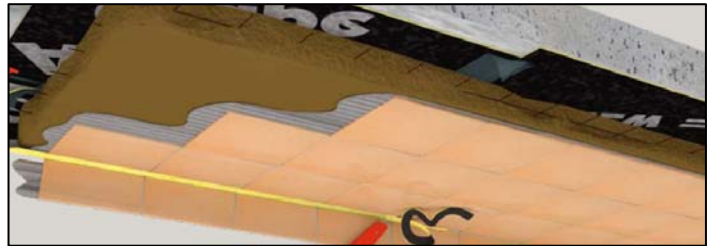

COMPOSITION

Thin layer of glass fibers glue-backed on a bituminous felt, surfaced by a plastic film and incorporated selvedge.

- Weight/m² : approximatly 690 g
- Surface : plastic film with selvedge
- Underface : Glass fiber (approximatly 230g)

PRESENTATION

- Thickness : 3 mm ± 0,5 mm
- Length : 20 m ± 0,2 m
- Width : 1 m ± 0,01 m
- Weight of a roll : approximatly 14,2 kg
- Rolls per pallet : 18

APPLICATION

- Underlayer for floating slab, in accordance with DTU 52.1.

SECURITY

It is not classified as dangerous according to the international regulation.

DOCUMENT DE REFERENCE ISO 9001

Our company is ISO 9001 certified	