

Paradiene JS R4

SBS elastomeric bitumen membrane with self-adhesive side laps as underlayer of a loose-laid two ply system under heavy protection



- ▶ Elasticity of the SBS elastomeric bitumen compound
- ▶ Resistance to cracking and puncturing of the polyester reinforcement
- ▶ Reliability of the self-adhesive side lap
- ▶ No use of separating underlay on insulation
- ▶ Thermal screen non requested on flame sensitive insulation (EPS, etc.)

Packing

Rolls of 2 x 12m each – Weight: 85kg

Main uses

Two-layer waterproofing system for flat roofs:

- non accessible terrace protected with ballast (slope 0 to 5%);
- pedestrian terrace with concrete slab (slope 1.5 to 5%);
- pedestrian terrace with slabs on adjustable supports (slope 0 to 5%);
- terrace accessible to vehicles with hard protection (slope 2 to 5%). Particularly suitable for application on flame-sensitive insulating panels.

Non accessible terrace protected with ballast

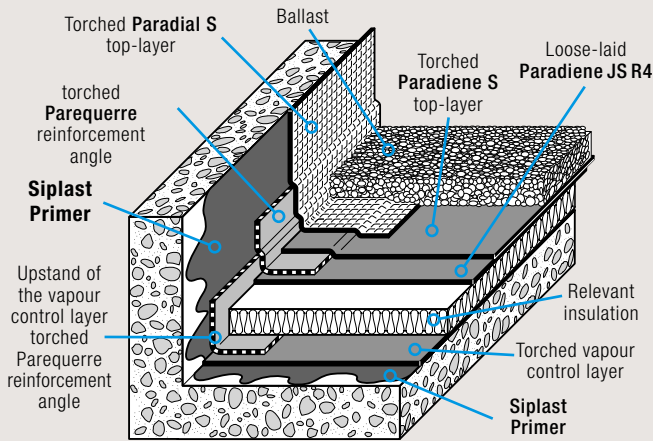

Pedestrian terrace with slabs on adjustable supports

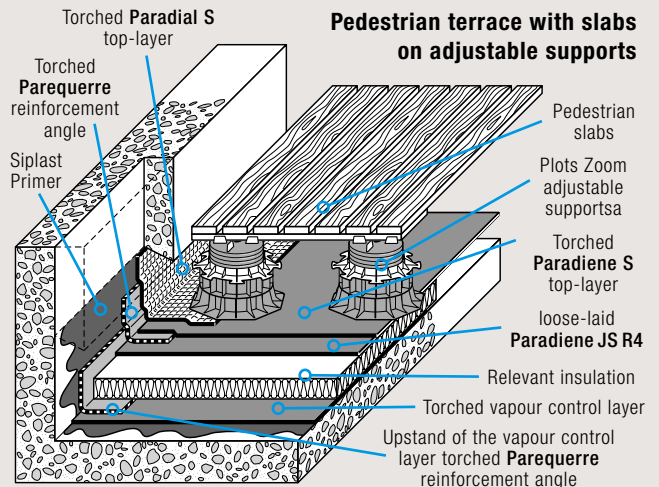

Pedestrian terrace with concrete slab

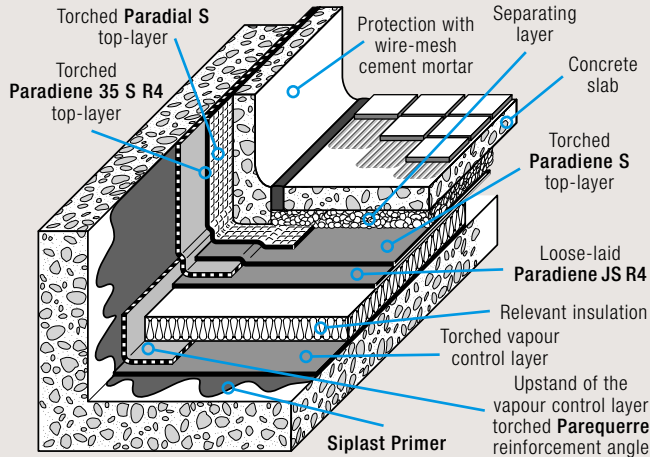

Terrace accessible to vehicles

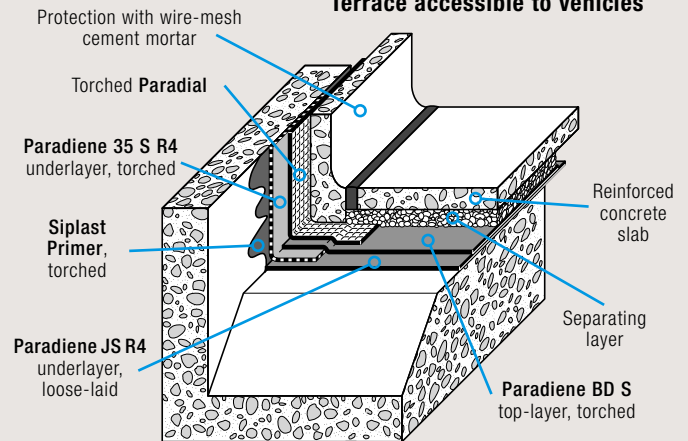

Description

- SBS elastomeric bitumen membrane with non woven polyester reinforcement
- Elastomeric bitumen compound: 3kg/m²
- Non woven polyester reinforcement: 0.180kg/m²
- Sand surfacing: 0.25kg/m²
- Underfacing with plastic film: 0.01kg/m², allowing for independent waterproofing
- Along side laps, connecting sides are protected by 2 peel-off siliconised paper strips
- Nominal thickness: 2.65mm (mini 2.50mm)
- Nominal weight: 3.4kg/m²

Performances

- Tensile strength (transversal): 550N/50mm
- Tensile strength (longitudinal): 750N/50mm
- Elongation: 40%
- Résistance to static puncturing: 20g (EN 12730)
- Résistance to dynamic puncturing: 20mm (EN 12691)

Application

Once placed Paradiene JS R4, peel off on the same time both siliconised paper strips from the side laps. Side laps stick one to the other, protecting thus the insulation from the torch flame. The heat released while torching the cap sheet fully secures the strong bond with a perfect weld.

Complementary information

- Paradiene JS R4 technical data sheet

Customs nomenclature

- 68.07.10.19.0.00.0.P.

Safety

Paradiene JS R4 is not rated as dangerous (for the applications described in this document)

This document is only a guide. Siplast-Icopal reserves the right to change the composition and fixing recommendations of products as a result of evolution of knowledge and technology.